



INDUSTRIAL PARK REALTY

A Mid-West Terminal Affiliate
Representing Over Two Million
Square Feet of Industrial Property

WWW.IPR-MWT.COM

For .PDF version or additional copies please
visit our website and select Available Properties.



115,200 TOTAL SQUARE FEET

For Lease 1490 Southern Road, Kansas City, MO

Available September 1, 2023

High Class B Building in Executive Park

LOCATION:

Intersection Southern Ave & Municipal

BUILDING SIZE:

115,200 Square Feet, 320' Deep x 360' Wide

CLEAR STACKING:

22' to 26' Center

COLUMN SPACING:

40' x 40'

ELECTRICAL SERVICE:

3000 Amp - 277/480 Volt, 3 Phase

SPRINKLER SYSTEM:

E.S.F.R.

FLOOR:

5" slab w/ 6x6 6/6 Mesh Reinforcement

LIGHTING:

LED - 30 fc

HEATING:

Cambridge System ~ 55° at 0°

WAREHOUSE A/C:

North Half of Warehouse is Air Conditioned

RAIL SERVED POTENTIAL:

9 Rail Doors - Kansas City Southern

TRUCK PAD DEPTH:

120' to Curb

DOCK DOORS:

East Side Main Dock

19 dock doors w/seals : 4 w/ Pits, 15 w/EOD

North Side

4 dock doors : 2 w/ Pits, 2 w/EOD

ACCESS:

- I-435 and the Chouteau Bridge
- I-35, M-210, and I-29
- Downtown K.C. Executive Airport
- 15 minutes to KCI Airport

OFFICE:

North Half (main office) approx. 7,125 square feet
South side (fulfillment office) approx. 2,000 square feet

CAR PARKING:

37 Car Parking in fenced lot

INDUSTRIAL PARK REALTY

1700 N. Universal Avenue, Kansas City, Missouri 64120

Joe LaMothe

David LaMothe

Phone: 816.231.8811

www.ipr-mwt.com

Fax: 816.231.0020

Information furnished regarding property is from sources deemed reliable but no warranty is made as to the accuracy thereof and same is submitted subject to errors, omissions, prior sale or lease or withdrawal without notice.

**FOR LEASE
115,200 SQUARE FOOT WAREHOUSE**

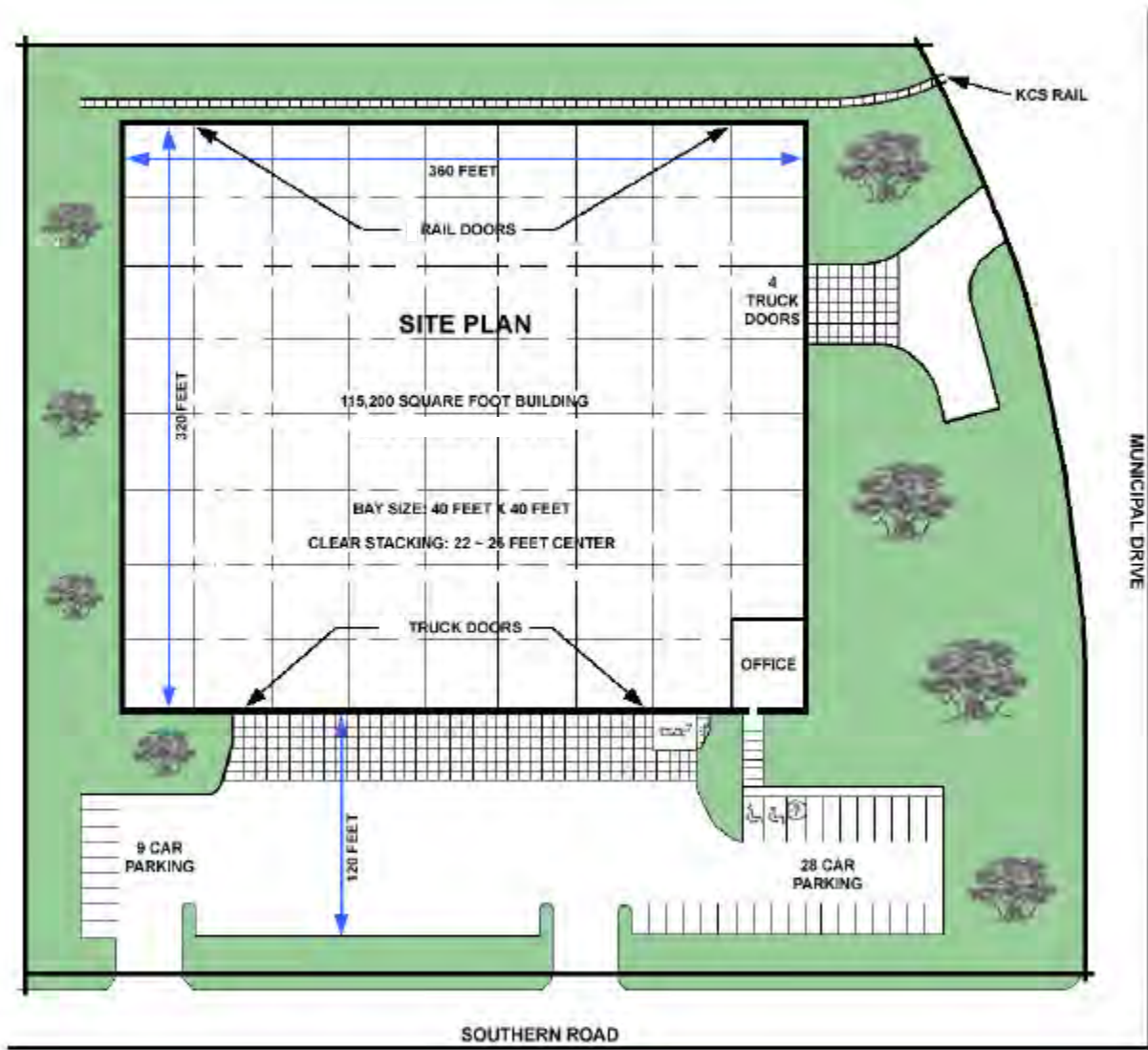

**1490 SOUTHERN ROAD
EXECUTIVE PARK - KANSAS CITY, MISSOURI**